

# *Live the Dream!*



## The Bass

3 Bedrooms  
3 Bathrooms  
2+ Car Garage / Golf Cart Parking

1st Floor .....1,450 sq. ft.  
2nd Floor .....375 sq. ft.  
**1,825 sq. ft.**

Garage .....480 sq. ft.  
Optional Sun Room ..... 125 sq. ft.  
Base Home with  
Added Sunroom ..... **1,950 sq. ft.**



# THE BASS 3 Bedrooms | 3 Bathrooms | 2+ or 3 Car Garage / Golf Cart Parking

## First Floor Plan Base

Building Overall Dimensions Appx. 28'x80'

1,450 sq. ft.

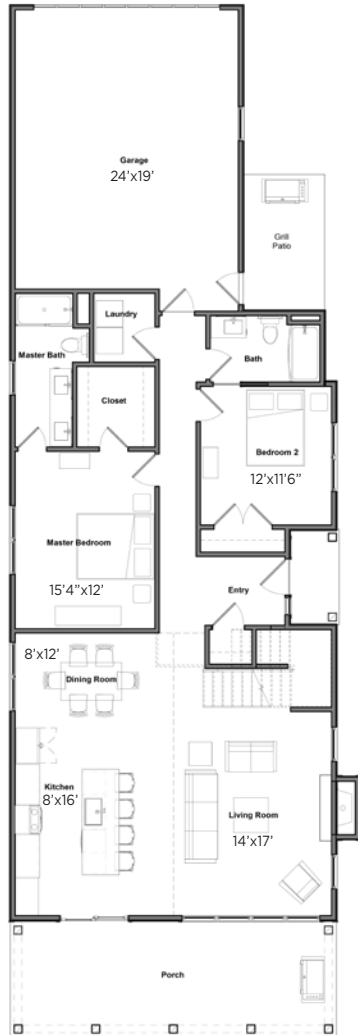

## Second Floor Plan Base

375 sq. ft.



## First Floor Plan with Optional Sunroom

1,575 sq. ft.



Sunroom can be placed on either side of the Living Room

## The Bass - Aspen White



Board+Batten  
Aspen White



Shake  
Cottonwood



Roof  
Moire Black



Metal Roof  
Black



## The Bass - Polaris



Board+Batten  
Polaris



Shake  
Cottonwood



Roof  
Moire Black



Metal Roof  
Black

Elevations, floor plans and landscaping are for illustration purposes only and may show optional features. Developer reserves the right to change without notice. All dimensions and Sq. Ft. listed are approximate. Construction plans may vary.

Temporary Sales Center located at 2663 NW Catawba Road, Port Clinton, OH 43452 | 419-797-0230 | FairwayCottagesCIC.com